

koraiLED 70W User Manual (Online Edition)

Part 1: Installation and Precautions

- 1.Safety Precautions
- 2.Operating Environment
- 3.Product Contents
- 4.Installation
5. APP Usage

Part 2: Features and Operating Instructions

- 1.User Interface
- 2.Detailed LED Light Settings
- 3.Main and Sub Light Settings
- 4.Schedule Settings
- 5.Scene Management

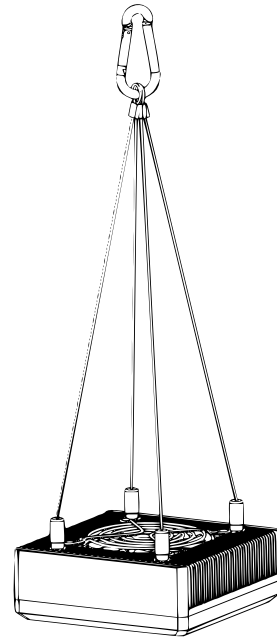

Part 1: Installation and Precautions

1. Safety Precautions

1.1 Prohibited Actions

- Do not touch the LED lens when the power is connected to avoid burns. Allow the fixture to cool before touching, adjusting, or servicing.
- Never stare directly into the LED light, regardless of its brightness, as it may cause eye damage.
- Do not place the LED light face down on any surface to prevent heat accumulation that could damage the LED itself.

1.2 Important Notes

- To avoid electric shock, exercise caution when operating near aquariums. Do not attempt to repair the equipment yourself. If the device malfunctions, it should be returned for repair or discarded.
- Do not use the device if the power cord or plug is damaged, malfunctioning, or otherwise compromised.
- Avoid allowing the device's plug or socket to become wet. A "drip loop" (Fig. 1) can be used to connect the aquarium equipment's power cord to the socket.
- Children are prohibited from using or touching the equipment. Supervise children closely if they are present near the device.
- Always unplug the device before removing or placing it into operation. Unplug it when not in use or during cleaning.

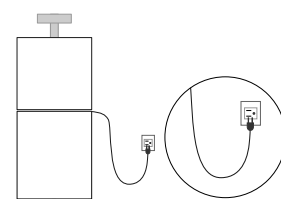

Fig.1

- Using accessories not sold or recommended by the manufacturer may pose risks.
- Before operation, ensure the device is securely installed on the aquarium.

2. Operating Environment

- This equipment is designed exclusively for indoor household aquarium use. Do not use it for other purposes.
- Avoid using the equipment outdoors or in environments below 0°C.
- This LED light is not a waterproof product. Do not submerge it in water. It contains electronic components that may be damaged by moisture.

3. Product Contents (Refer to Fig. 2)

- LED Main Unit (1-1)/Bracket Assembly (2-1, 2-2)/Suspension Kit (3-1)/Power Supply (4-1, 4-2)/Accessories - Rubber Pads (5-1)/Accessories - Screws (6-1)/Manual (7-1)

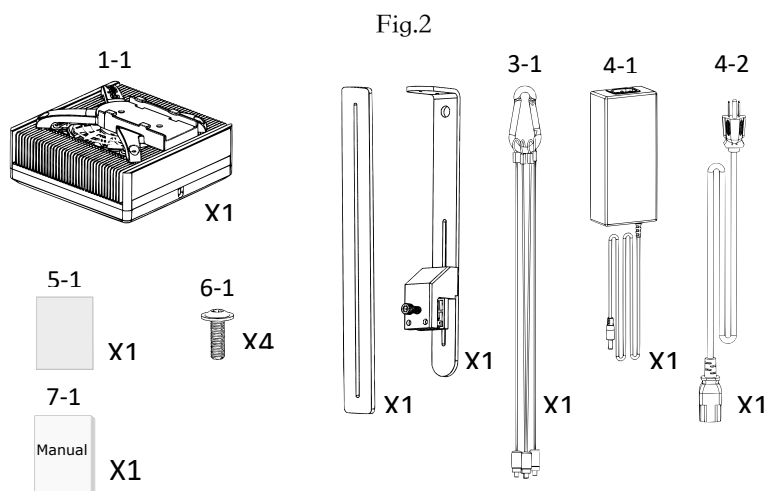

4. Installation

4.1 Connecting Power

- Connect the DC plug of the LED light to the power supply, then plug the AC power cord into the power supply socket.
- After powering on, press and hold the switch button for 3 seconds (Fig. 3-A). Check if the indicator light (Fig. 3-B) is illuminated. If not, verify that the AC power cord is correctly connected.

4.2 Mounting Options

- Install the LED light above the aquarium and ensure all components remain dry. Depending on your needs, you can choose between bracket mounting or suspension mounting (refer to Fig. 4 and Fig. 5).
- Adjust the height and distance accordingly to complete the installation. If using the bracket mounting option, attach the rubber pads as shown in the diagram to enhance stability.

4.3 Installation Notes

- Ensure proper ventilation around the top and sides for efficient heat dissipation.
- The operating environment temperature should remain below 40°C (77°F).
- Keep at least 15 cm (6 inches) between the bottom of the LED light and the water surface.
- Securely fix the LED light to avoid it falling from the bracket.

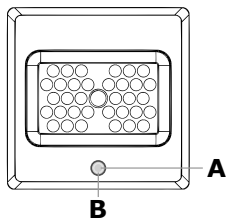

Fig.3

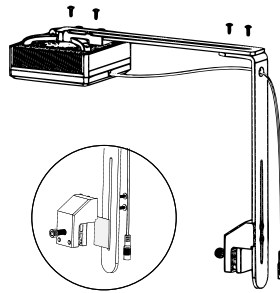

Fig.4

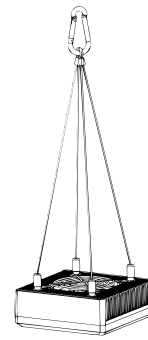

Fig.5

5. APP Usage

This device is controlled via the koralCore APP and connects through Bluetooth. Search for "koralcore" in the App Store or Google Play to download the app (refer to Fig. 5).

1. Bluetooth Connection: Press the power button to enable Bluetooth pairing mode. The device name will appear as koralLED 70W.
2. For detailed instructions on using the koralCore APP, visit the official support page at www.reefb.com/support to view or download the manual.

Note: Due to software and hardware upgrades and updates, the actual operation may slightly differ from the product description. Please follow the instructions for the current version.

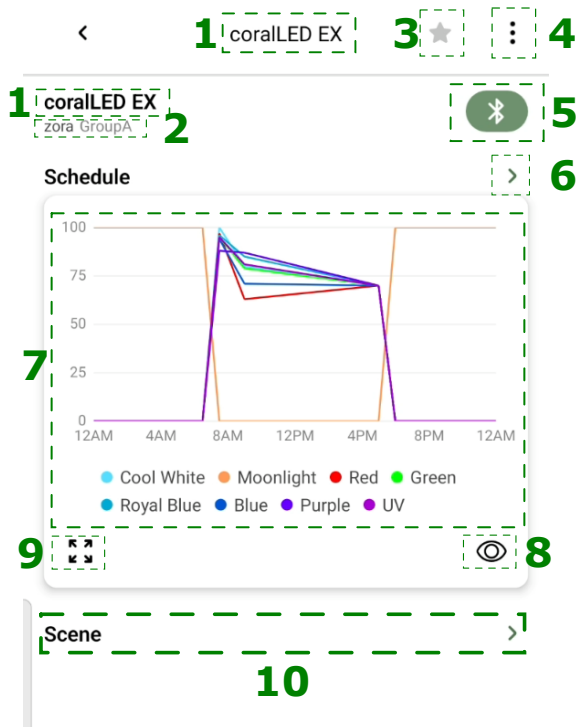

Fig.5

Part 2: Features and Operating Instructions

1. koralLED Interface

koralLED provides an intuitive and flexible interface. You can quickly complete the initial setup by following these steps:



- 1.LED Light Name
- 2.Associated Tank (Salt) and Group within the Tank (Group A)
- 3.Tap "★" for frequently used devices, "★" for general devices
- 4.koralLED Settings, including: Edit Settings | Delete Device | Set as Main Light | Reset to Default
- 5.Tap "📶" to connect, "📶" to disconnect
- 6.Tap "➤" for Schedule Settings
- 7.Spectrum Schedule Graph
- 8.Tap "🕒" for a one-minute preview
- 9.Tap "🔍" to enlarge the schedule graph in landscape mode
- 10.Scene Management Area
- 11.Schedule Settings

12.Scene Management

2. koralLED Detailed Settings

Tap the top-right menu "☰" to access detailed settings, which include:

- Edit: Enter edit mode to set the device name and tank location.
- Delete: Remove the current device.
- Reset to Default: Clear all schedules while retaining the device registration. After resetting, the device will only appear in the "Unassigned Tank" section on the homepage.

3. koralLED master and slave Light Settings

3.1 Configuring master and slave Lights

For multiple lights in the same tank:

- Divide the lights into "master Light" and "slave Lights" for synchronized control of all lights in the group.
- By default, the first connected light in the group is set as the master Light, while the others are set as slave Lights.

- You can create up to 5 groups (A to E), with a maximum of 4 lights per group.
- Manually switch the Main Light or adjust the group structure as needed.

3.2 Switching master Light and Moving to a New Group

1. Switching the master Light

- Go to the LED light homepage, tap "☰" and select "Set as Master" to enter the configuration.
- Select a non-master light "⋮" and set it as the master Light.

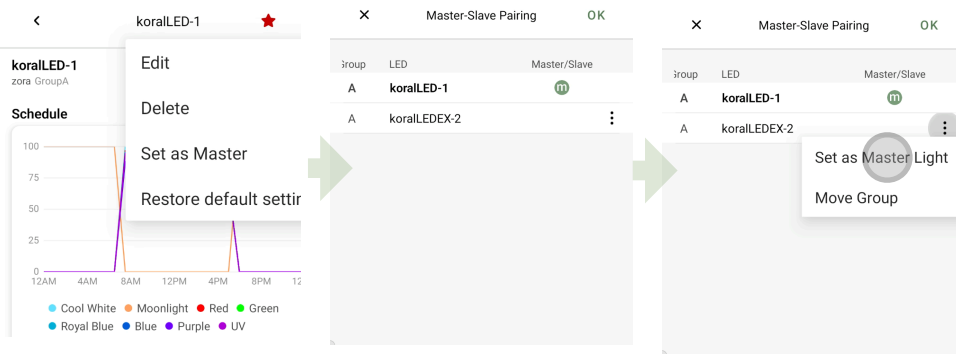

2. Moving to a New Group

- Go to the LED light homepage, tap "☰" and select "Set as Master" to enter the configuration.
- Select a non-master light "⋮", then choose "Move Group" to assign it to a new group.

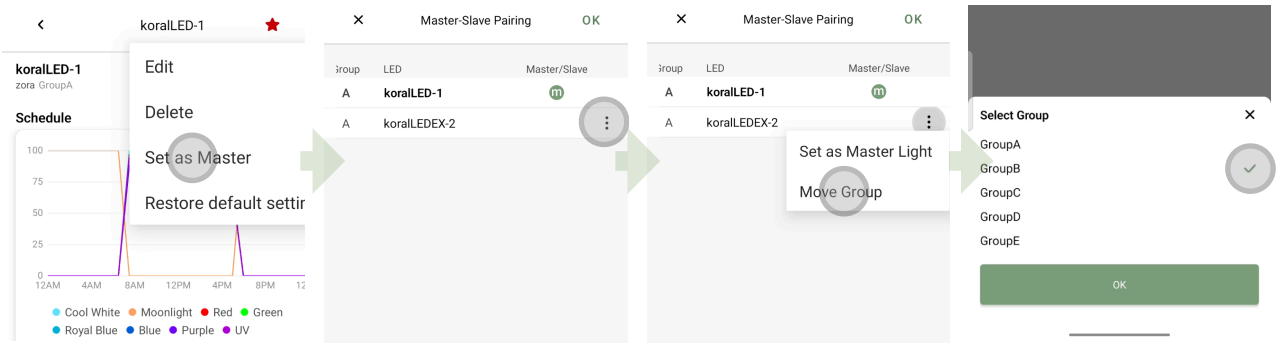

4. Schedule Settings

The koralCore APP provides a convenient and flexible LED lighting schedule management feature. The process includes:

- Quick Schedule Setup: Establish an initial schedule plan.
- Detailed Schedule Editing and Spectrum Planning: Adjust schedule details and set spectrum parameters as needed.

4.1 Quick Schedule Setup

In its initial state, koralLED does not have any schedule configured. You can complete the setup in 50 seconds using the quick setup feature:

- From the APP's main screen, tap koralLED to access the schedule settings.

- Tap "Schedule Settings" to enter the quick setup screen.
- Configure the following:
 - a. All Spectrum Intensities: Default is set to 50%.
 - b. Sunrise and Sunset Times: Default sunrise is at 06:00, and sunset is at 18:00.
 - c. Moonlight: Brightness range from 0% to 100%.
 - d. Smooth Start: Gradually transitions from night to sunrise.

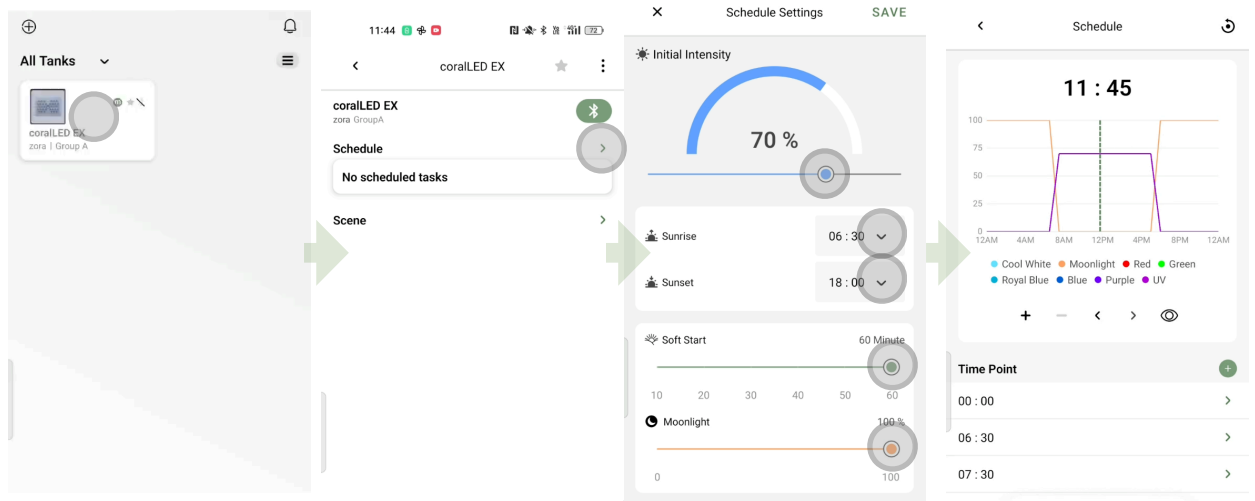

4.2 Detailed Schedule Editing and Spectrum Planning

The coralCore APP offers a visual scheduling feature that allows users to precisely adjust spectral parameters for each time point.

Visual Scheduling Tools:

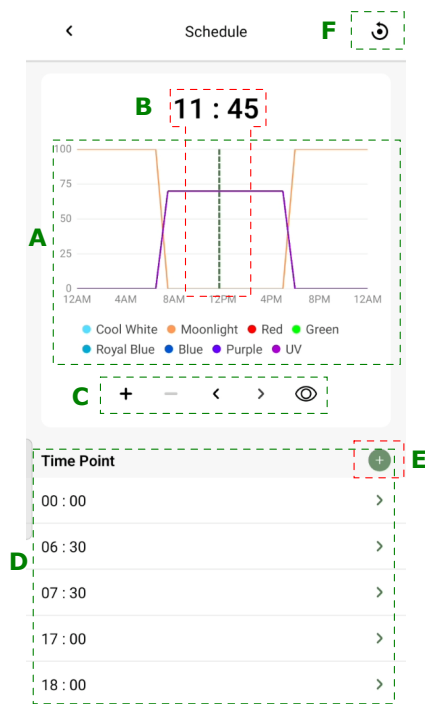

- A. Visual Schedule Graph
- B. Time Indicator Line: Displays the current time position of the LED light.
- C. Schedule Editing Tools:
 - + : Add a time point
 - : Delete a time point
 - < : Move the time point forward
 - > : Move the time point backward
 - 🔄 : One-minute quick preview (preview the entire 24-hour schedule in one minute)
- D. Time Point Area: Tap ">" to adjust the spectrum for a specific time point.
- E. Tap "+" to add a time point and directly enter spectrum editing mode.
- F. Tap "🔄" to clear all schedule content. You can then reconfigure using the quick schedule setup.

4.3 Operation Methods

4.3.1 Adding a Time Point

Method 1:

- Drag the schedule line to the desired time position.
- Tap "+" to add a new time point.
- Tap the newly added time point to enter spectrum editing mode.

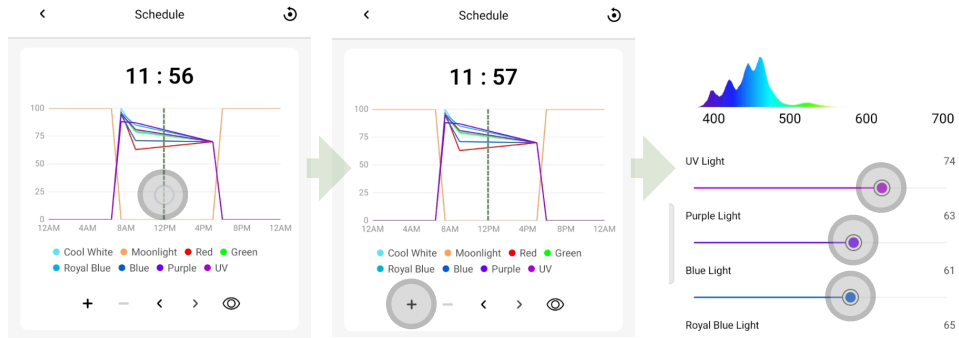

Method 2:

Tap the "+" icon in the Time Point Area to directly add a time point and enter spectrum editing mode.

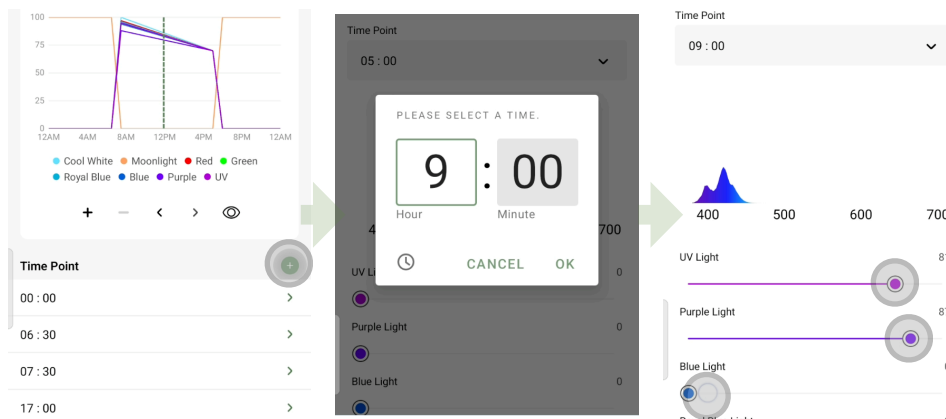

4.3.2 Deleting a Time Point

- Use the scheduling tools "<" or ">" to navigate to the time point you wish to delete.
- Tap the "-" icon to delete the selected time point.

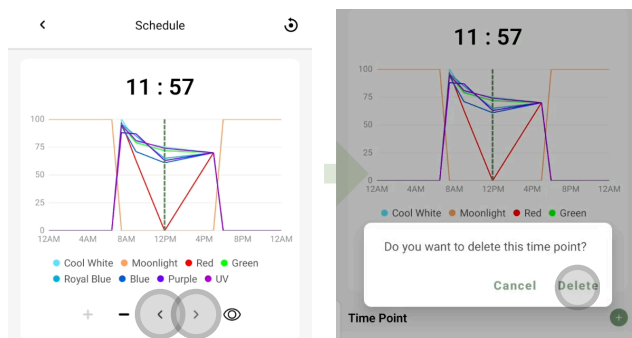

4.3.3 Spectrum Editing

- Tap the ">" icon next to the time point you want to edit to enter the spectrum settings screen.
- Adjust the spectral parameters as needed.
- Tap "Save" to complete the settings.

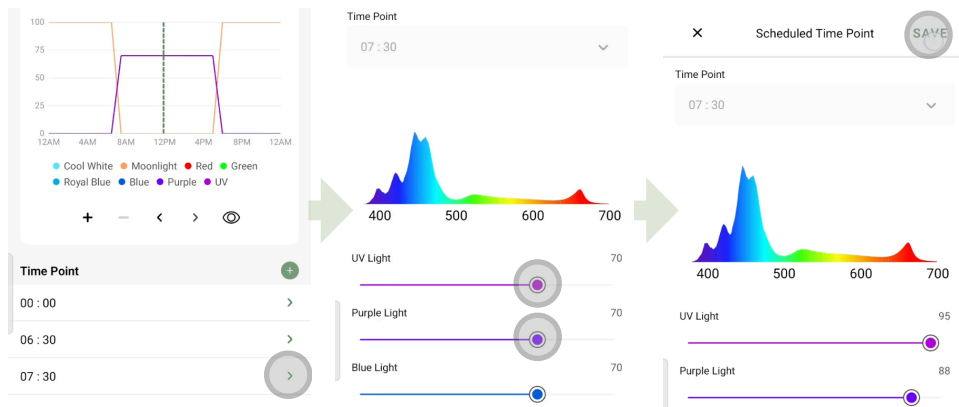

4.3.4 Clearing the Schedule

- Enter the schedule settings screen.
- Tap "🔄" to clear all schedule content.
- Tap "OK" to automatically enter the quick schedule setup mode.

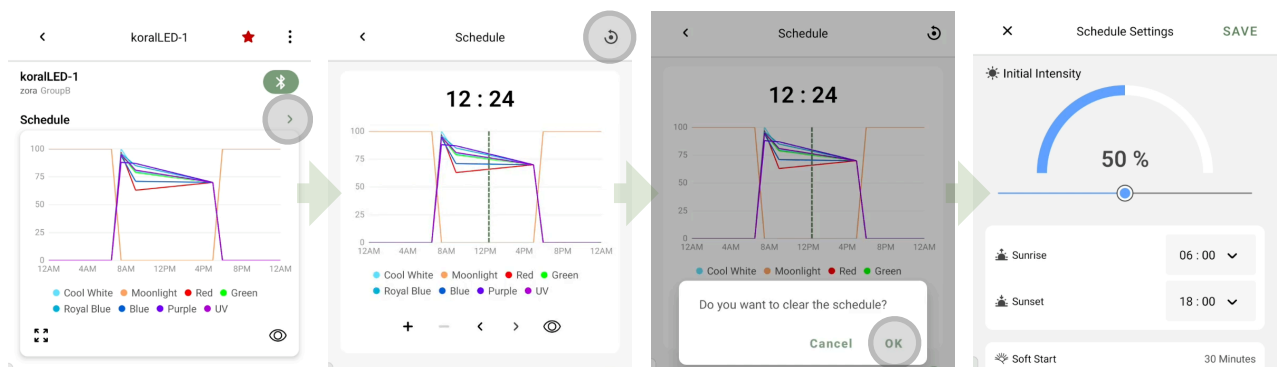

5. Scene Management

korallED provides a scene management feature that supports both built-in default scenes and customized scene settings, enhancing the user's enjoyment during the cultivation process.

Note: Executing a scene will pause the schedule. After completing the operation, please switch back to schedule mode.

5.1 Setting Favorite Scenes

- Enter the scene settings screen and tap the "★" icon next to your favorite scene to mark it as a red star "★".

2.The setting is complete.

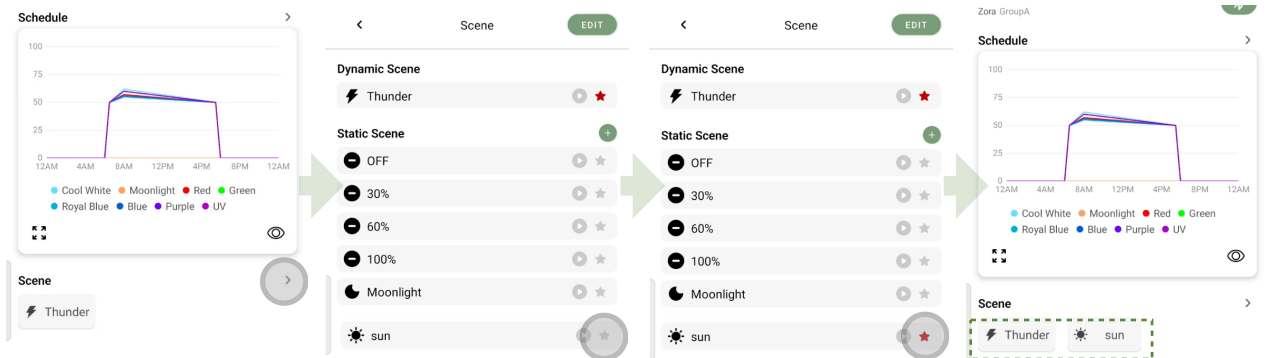

5.2 Adding Customized Scenes

1. Tap ">" in the scene area to enter the scene settings screen.
2. Tap the "+" icon to start adding a new scene.
3. Enter "Scene Name" , "Scene Symbol" "Scene Spectrum"
4. Tap "Save" to complete the setup.

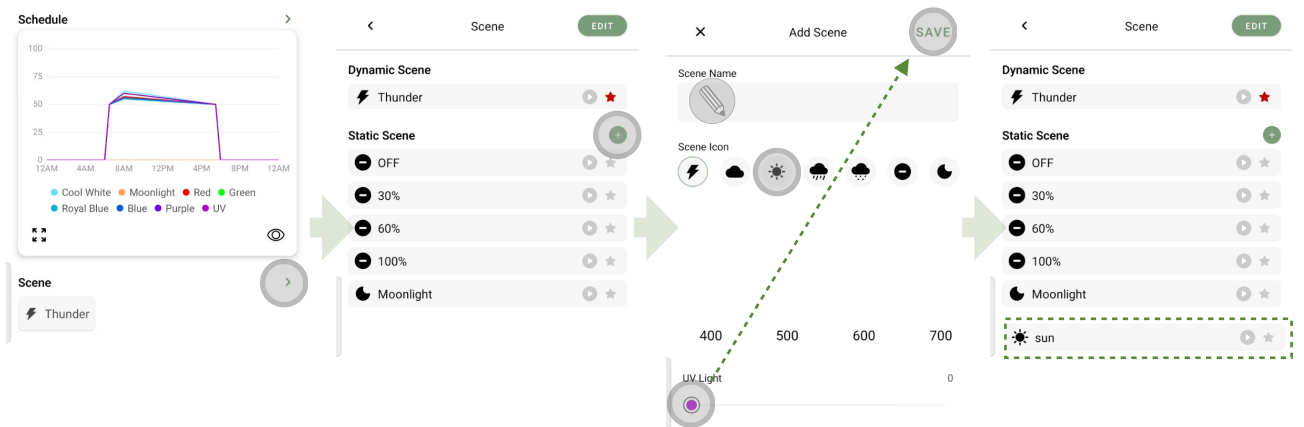

5.3 Deleting Scenes (Applicable to Customized Scenes Only)

1. Tap "Edit" in the upper-right corner of the scene settings screen.
2. Select the scene you wish to delete.
3. Follow the on-screen instructions to complete the deletion.

